

KEY FEATURES

- High sensitivity: 97,5 dB
- Extended frequency range: 5 - 20 kHz
- Neodymium magnet
- 1" edgewound aluminum voice coil
- PM4 diaphragm
- Enhanced technology for higher power handling: 30 W_{AES}
- Compact design
- Designed for high frequencies reproduction

TECHNICAL SPECIFICATIONS

Rated impedance	4 Ω
Minimum impedance	4,5 Ω
D.C. resistance	3,5 Ω
Power capacity*	30 W _{AES} above 5 kHz
Program power	60 W above 5 kHz
Sensitivity**	97,5 dB 1W @ 1m @ Z _N
Frequency range	5 - 20 kHz
Recommended crossover	5 kHz or higher (12 dB/oct min.)
Voice coil diameter	25,4 mm 1 in

DIMENSION DRAWINGS

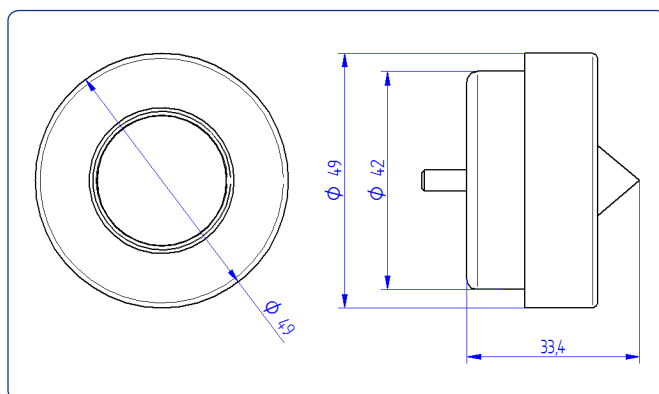

FREQUENCY RESPONSE

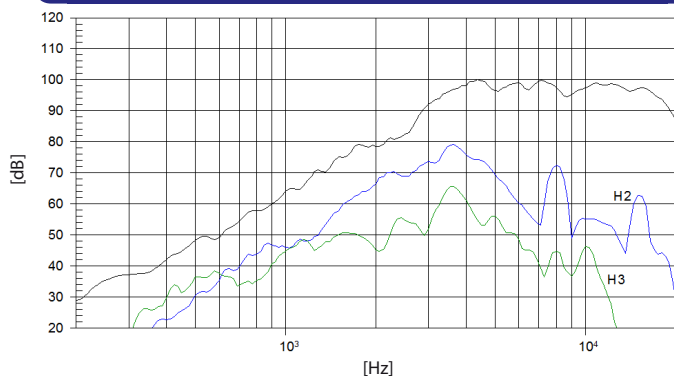

Note: On axis frequency response measured in anechoic chamber, 1W @ 1m

MOUNTING INFORMATION

Overall diameter	49 mm	1,93 in
Depth	33 mm	1,30 in
Net weight	0,2 kg	0,44 lb
Shipping weight	0,6 kg	1,32 lb

Notes:

* The power capacity is determined according to AES2-1984 (r2003) standard. Program power is defined as the transducer's ability to handle normal music program material.

** Sensitivity was measured at 1m distance, on axis, with 1W input, averaged in the range 5 - 18 kHz.